

## STEP 1

Invert the 5 leg base. Press-fit the casters in the locations shown.

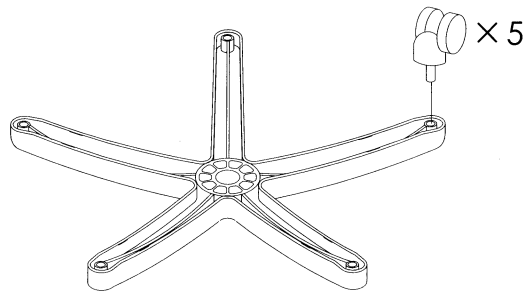

## STEP 2

For ease of assembly, invert the seat cushion. The empty carton provides an ideal surface for steps 2 - 5. Tighten securely each arm to the seat cushion with three allen head screws and washers as depicted in the illustration.

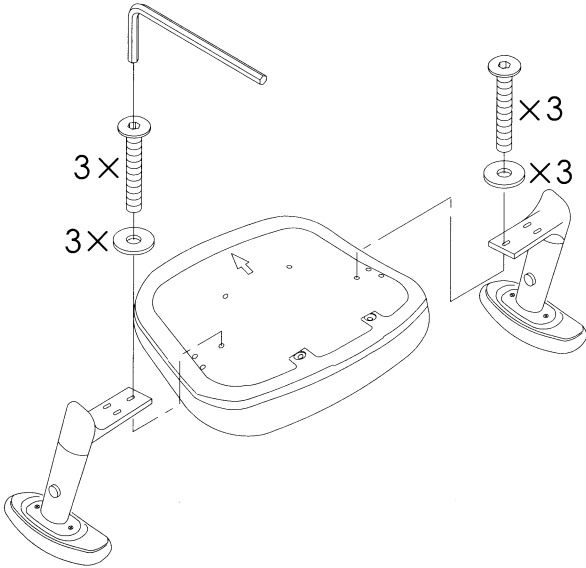

## STEP 3

Align the seat plate with the pre-drilled holes near the seat cushion center. The large knob should face the front of the cushion. Tighten the four flanged allen head screws.

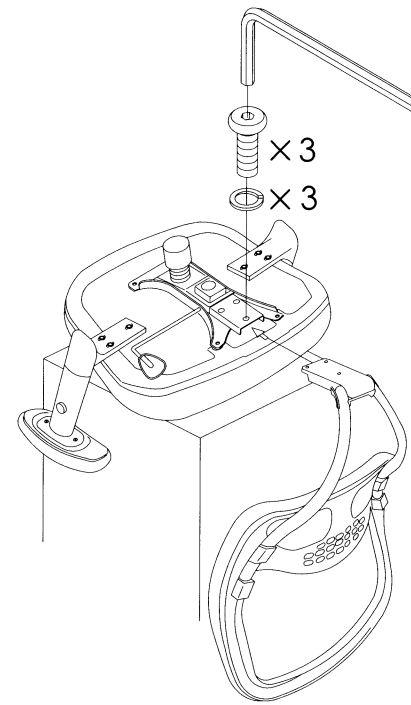
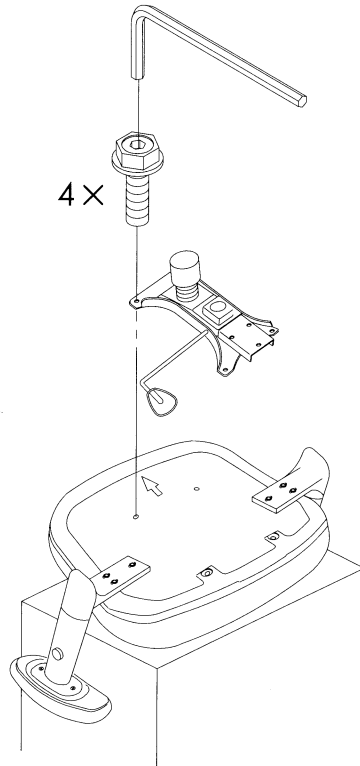

## STEP 4

Attach the seat back to the cushion bottom with three allen head screws and lock washers. Tighten securely with the allen wrench provided.

## STEP 5

Place the base on the floor with the caster side down. Insert the pneumatic support into the center hole of the base. Align the top half of the chair assembly as shown and press downward to firmly secure.

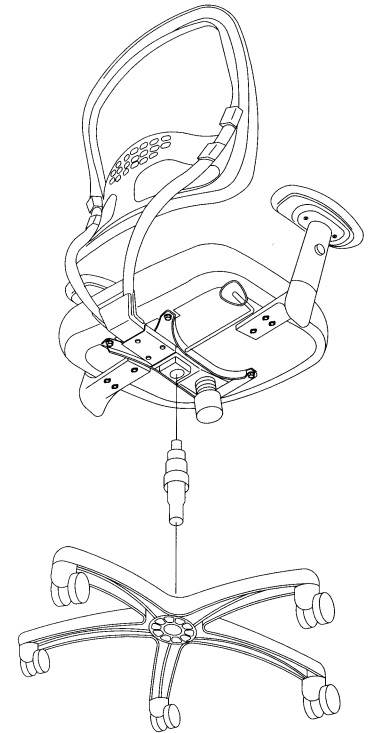

**Warning:** It is unsafe to use this product for activities other than it was designed for. Never kneel or stand on the chair. Doing so may result in serious injury.  
Time of use and type of use varies by individual. To maintain longevity and reliability of components, check all assembly screws every 3 months. Tighten as needed.